



SpeedFace-V4L Pro Series

Linux-Based Hybrid-Biometric Access Control & Time and Attendance Terminal with Full Spectrum of Authentication Options



Facial Recognition



RFID



Fingerprint



QR Code



IP65 dust & waterproof rating



SpeedFace-V4L Pro



SpeedFace-V4L Pro-QR



SpeedFace-V4L Pro-RFID

Compatible with **ZKBio Access**

SpeedFace-V4L Pro Series using intelligent engineering facial recognition algorithms and the latest computer vision technology. It supports Fingerprint, facial, QR code verification with large capacity and speedy recognition, as well as improves security performance in all aspects.

SpeedFace-V4L Pro Series adopts ultimate antispoofing algorithm for facial recognition against almost all types of fake photos and videos attack. Besides, its specialised QR module supports QR code, PDF417, Data Matrix, MicroPDF417, Aztec, and so on.

SpeedFace-V4L Pro support video intercom via mobile app ZSmart, also they are integrated with ZKBioTime Cloud ZKBioAccess IVS Mobile APP support Dynamic QR code for T&A/A&C.

Features

- Visible light facial recognition technology and in-glass fingerprint verification
- Darklight Facial Recognition without LED Flash
- IP65 water and dust resistance
- Support facial / fingerprint / scramble QR Code / RFID
- Supports multiple RFID modules:125KHz ID card / 13.56MHz IC card / ID&IC card
- Supports up to 50,000 facial / 500,000 fingerprint / 500,000 RFID card / 3,000,000 records
- HD video door phone via ZSmart mobile App / SIP Protocol

Specifications

Product Model	SpeedFace-V4L Pro	SpeedFace-V4L Pro-QR	SpeedFace-V4L Pro-RFID
Display	4-inch color TFT LCD	4-inch color TFT LCD	4-inch color TFT LCD
LED	Multiple colors	Multiple colors	Multiple colors
Sensor Type	Optical Sensor	QR-Code	RFID
Extractor/Matcher	MINEX certified and compliant	MINEX certified and compliant	MINEX certified and compliant
Template	ISO 19794-2/ANSI 378		
Mobile card	NFC	NFC	NFC
Biometric	Fingerprint+Face	Face Only	Face Only

RFID	13.56MHz /125KHz ID card / IC card / ID&IC card	13.56MHz /125KHz ID card / IC card / ID&IC card	13.56MHz /125KHz ID card / IC card / ID&IC card
User Capacity	500,000	500,000	500,000
Card Capacity	500,000	500,000	500,000
Face Capacity	50,000	50,000	50,000
Fingerprint Capacity	500,000	/	/
Credential	FingerPrint=20,000(1:N), 500,000(1:1), Card=500,000(1:1)	Card=500,000(1:1)	Card=500,000(1:1)
Logs Capacity	3,000,000	3,000,000	3,000,000
Hardware	1GHz A53 Dual Core CPU,1GB RAM+8GB Flash,2MP Binocular Camera, IEEE 802.11a/b/g/n/ac 2.4GHz+5GHz Wi-Fi		
Crypto Chip	Supported	Supported	Supported
Sound	16-bit	16-bit	16-bit
Tamper	Supported	Supported	Supported
Facial Recognition Speed	<1s	<1s	<1s
Facial Recognition Distance	0.5m to 2m	0.5m to 2m	0.5m to 2m
Communication	TCP/IP (Ethernet-10/100Mbps, auto MDIX), Wi-Fi (Built-in), Intercom, Wiegand (1Ch Input, 1Ch Output), RS485(1ch Host or Slave (Selectable)), USB 2.0 or 3.0		
TTL Input	Aux Inputs *1, Alarm output*1, Wired Doorbell*1, Door Sensor*1, Exit Button*1;Totally 3Ch Input and 2ch output		
Relay	1 Relay		
Standard Functions	ADMS, DST, Camera, 14-digit User ID, T9 Input, Record Query, Tamper Switch Alarm, Multiple Verification Methods, Anti-Passback, Wired doorbell, Schedule Bell, Https		
Access Control Interface	3rd Party Electric Lock, Door Sensor, Exit Button, Alarm output, Auxiliary Input		
Power	12V 3A	12V 3A	12V 3A
PoE	Supports IEEE 802.3af	Supports IEEE 802.3af	Supports IEEE 802.3af
Power and license	Power Adapter and necessary license provided		
Ingress Protection Rating	IP65	IP65	IP65
Operating Temperature	-20°C to 50°C	-20°C to 50°C	-20°C to 50°C
Operating Humidity	10% to 90% RH	10% to 90% RH	10% to 90% RH
Dimensions(L*W*D)	183*88*20.5mm	183*88*20.5mm	183*88*20.5mm
Supported Softwares	ZKBioTime Cloud/AccessIVS/ ZSmart App and all Standard API		

Configuration

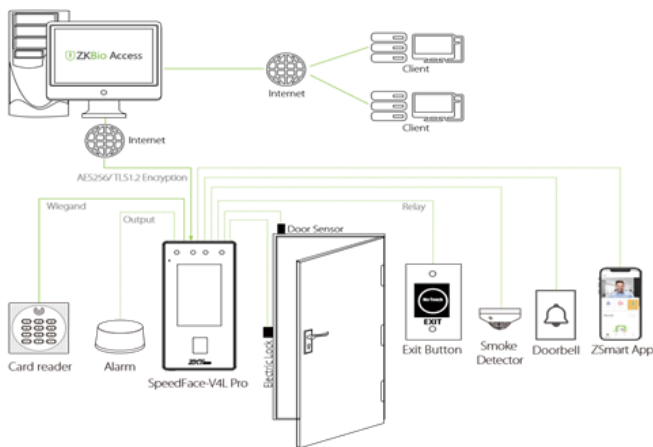

Dimensions (mm)

